

EH72

DIMENSIONS



SPECIFICATIONS

Model name	EH72
Type	Air-cooled, OHV, V-twin, Horizontal shaft
Bore x Stroke	84 x 65 mm
Displacement	720 cm ³
Maximum output (Net)	17.2 kW @3600 r/min
Rated output (Net)	14.2 kW @3600 r/min
Maximum torque (Net)	51.0 N·m @2800 r/min
PTO Shaft Rotation	Counterclockwise (from PTO shaft side)
Fuel	Unleaded gasoline
Lubricant	API classification: SE or higher class SAE viscosity index: 10W-30
Oil Capacity	1.55 L (including oil filter)
Ignition System	Twin TCI
Spark Plug	NGK BPR5ES
Starter	Electric starter
Governor	Centrifugal flyweight type
Air cleaner	Dual element
Carburetion system	Twin choke side draft
Lubrication System	Full filtered pressure lube
Charging Capacity	12V - 15A
Dry Weight	51.5 kg
Dimension (L x W x H)	463 x 499 x 476 mm
Approved regulation*	EPA III, CARB III, EC II, LEMA III

*Applicable in variation

PTO. Shaft variations

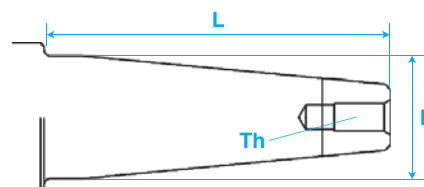

K shaft: 2.25/12 Taper

Type	L	D	Th
K	78.7mm	35.0mm	5/16-24UNF

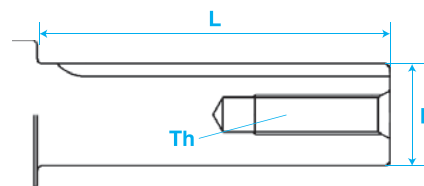

A shaft: Straight, SAE
B shaft: Straight, metric

Type	L	D	Th
A	99.3mm	28.6mm	7/16-20UNF
B	80.0mm	35.0mm	M10x1.25

PERFORMANCE CURVE

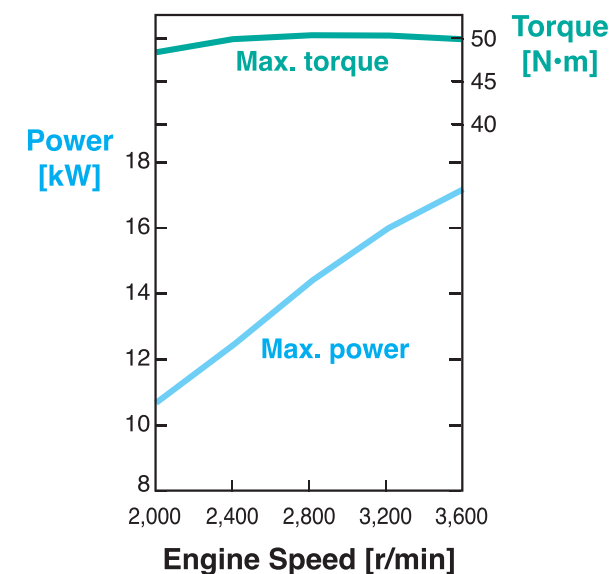

EH72 DIMENSIONS

